

# CRUISE CONTROL SYSTEM

## PRECAUTION

### 1. DISCONNECT AND RECONNECT CABLE OF NEGATIVE BATTERY TERMINAL

- (a) Before performing electronic work, disconnect the cable from the negative (-) battery terminal in order to prevent it from shorting and burning out.
- (b) Before disconnecting and reconnecting the battery cable, turn the ignition switch OFF and the headlight dimmer switch OFF. Then loosen the terminal nut completely. Do not damage the cable or terminal.
- (c) When the battery cable is disconnected, the clock and radio settings and stored DTCs are erased. Therefore, before disconnecting the battery cable, make a notes of them.

### NOTICE:

**When the cable is disconnected from the negative (-) battery terminal, initialize the following system(s) after the cable is reconnected.**

System name	See procedure
METER / GAUGE SYSTEM	ME-10

**CC**

### 2. HANDLING PRECAUTION FOR CRUISE CONTROL SYSTEM

- (a) Turn the cruise control main switch off when not using the cruise control system.
- (b) Be careful as the vehicle speed increases when driving downhill with the cruise control system on.
- (c) The + (ACCEL)/RES (RESUME) operation changes according to the cruise control system status. When the cruise control system is operating, the + (ACCEL) function operates. When the cruise control system is not operating, the RES (RESUME) function operates.
- (d) If the CRUISE main indicator light blinks while the cruise control system is operating, turn the cruise control main switch off to reset the cruise control system. After the reset, if the cruise control main switch cannot be turned on, or the cruise control system is canceled immediately after turning the cruise control main switch on, the system may have a malfunction.
- (e) Do not use the cruise control system where the road conditions are as follows:
  - Heavy traffic
  - Steep decline
  - Roads with sharp turns
  - Icy or snowy roads
  - Slippery roads

# PARTS LOCATION

CC

ENGINE ROOM R/B NO. 2  
- STOP FUSE

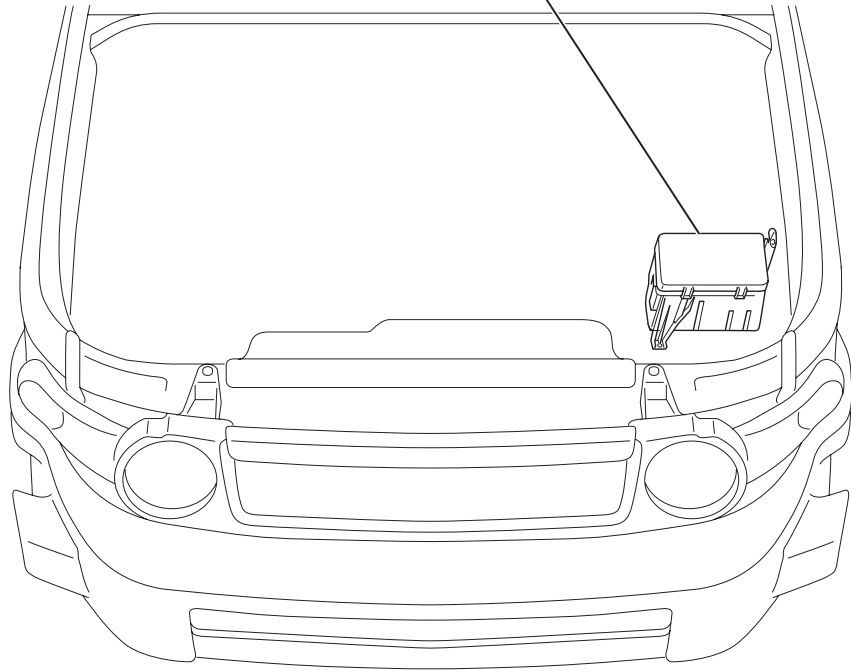

MAIN BODY ECU (DRIVER SIDE J/B)

- IGN FUSE
- GAUGE FUSE
- ECU-IG FUSE

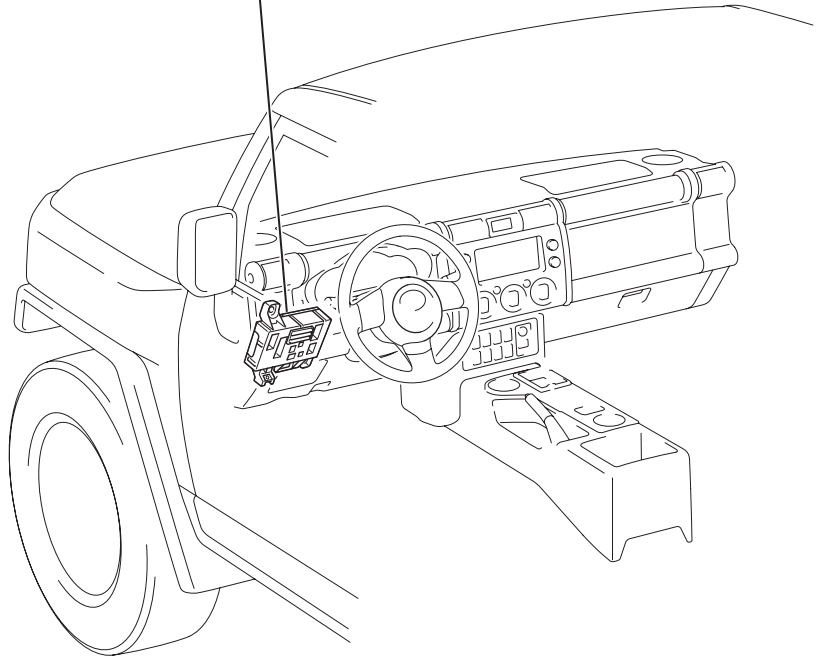

COMBINATION METER ASSEMBLY  
- CRUISE MAIN INDICATOR LIGHT

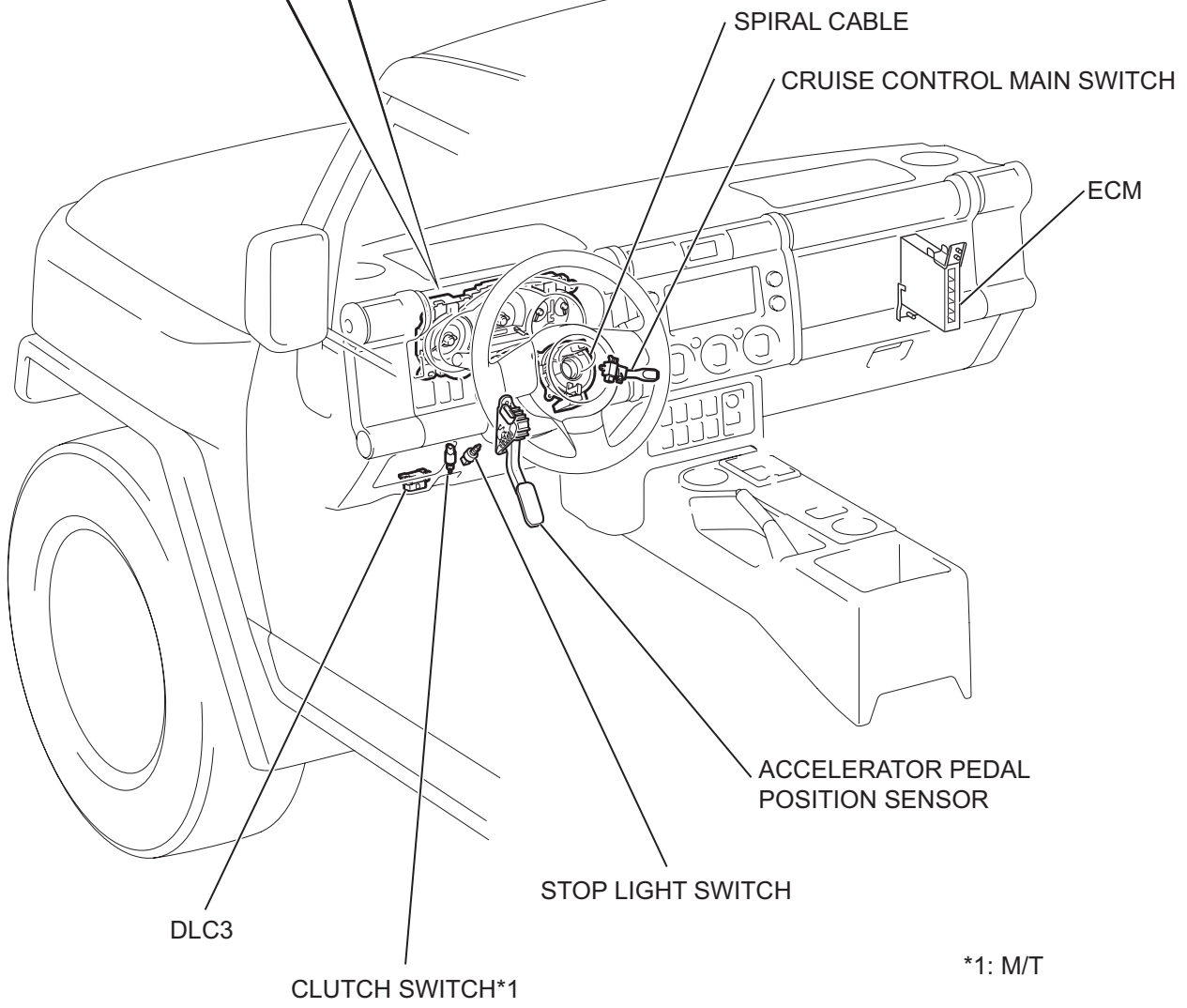
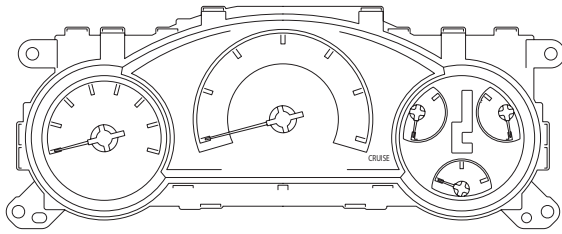

\*1: M/T

CC